

# AacerChannel™ VLP

## FIXED RESILIENT SYSTEMS

The AacerChannel™ VLP performance floor system provides the resiliency and safety of a floating floor and the stability of an anchored system. AacerChannel VLP offers a low profile which can also be considered if satisfying certain heights in retrofit projects.



INFINITY  
Wood Floors



# AacerChannel™ VLP

AacerChannel™ VLP is a fixed resilient sports performance floor system that features a monolithic subfloor with full flex and a full thickness APA engineered underlayment to maximize system performance. The result is a floor with increased stability, shock absorbency, energy return and low vibration.

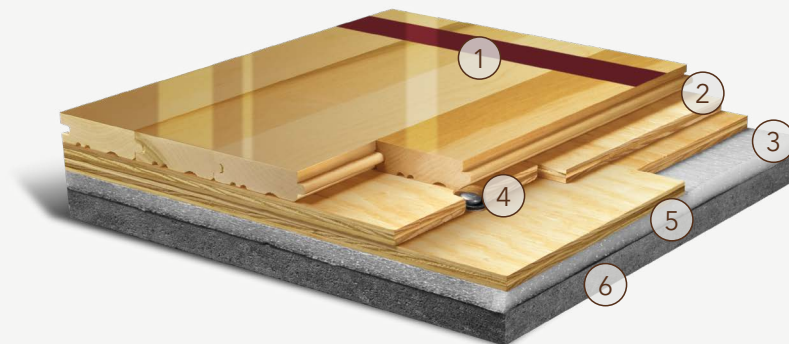

1. Infinity MFMA Maple
2. Integrated Panels form a Monolithic Subfloor
3. Performance Foam
4. Collared Steel Drive Pin
5. Vapor Retarder
6. Concrete

## WALL BASE

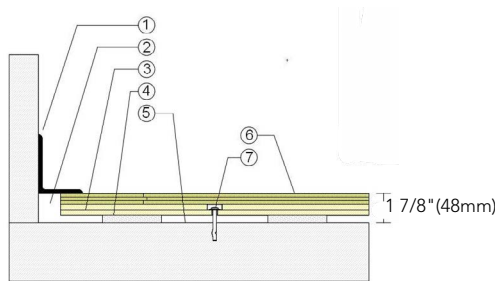

1. 3" x 4" (76mm x 101mm) Vent Cove Base
2. 1 1/2" (38mm) Min. Expansion Space
3. AacerChannel VLP Subfloor Panel
4. Resilient Foam Section
5. Vapor Retarder
6. 25/32" (20mm) MFMA Maple Flooring
7. Collared Steel Concrete Anchor

## THRESHOLD

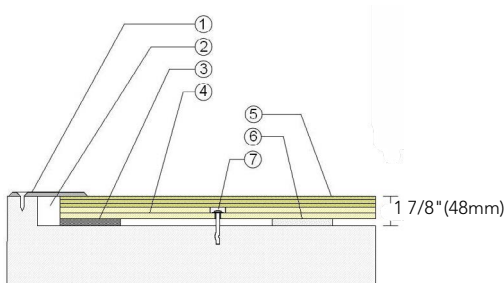

1. 1/4" (6mm) Aluminum Threshold
2. 1 1/2" (38mm) Min. Expansion Space
3. Solid Blocking at Doorway
4. AacerChannel VLP Subfloor Panel
5. 25/32" (20mm) MFMA Maple Flooring
6. Resilient Foam Section
7. Collared Steel Concrete Anchor

## EQUIPMENT

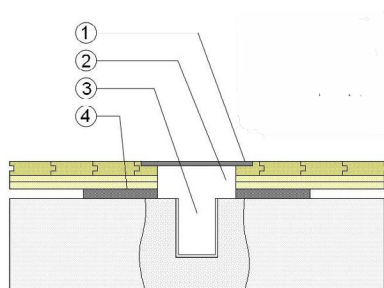

1. Floor Plate
2. 1 1/2" (38mm) Min. Expansion Space Required at all Insert & Electrical Penetrations
3. Concrete Floor Penetration
4. Solid Blocking at Insert

## Anchorage

## Certified

## Drill and Pin



## Green Status and LEED Contributors



- FSC® Certified Maple - MR
- FSC® Certified Subfloor Components - MR
- Environmental Quality - EQ
- Regional Materials - MR

## Resilience

1/2" (12mm) Performance Foam  
\*Other pad options available.

## Slab Depression

- 25/32" (20mm) flooring  
-1 7/8" (48mm)

## Optional AacerChannel Systems

AacerChannel VLP HC

## Subfloor Construction

Pre-manufactured panels

## System Type

Fixed Resilient

## Testing Laboratory Partners



It is the policy of Infinity Wood Floors to continuously improve its line of products. Therefore, Infinity Wood Floors reserves the right to change, modify or discontinue systems, specifications and accessories of all products at any time without notice or obligation to purchaser.



see us at  
**Sweets.com**



Jan2023